

Multi-way boulevard is a new street type in San Francisco which combines efficient through-traffic travel with calmed local access lanes for neighborhood commercial and residential use.

**Existing Challenges Include:**

- Side access lane widths are often too wide and have resulted in fast moving cut-through traffic using these lanes
- Need to maintain adequate width for emergency vehicle access
- Better urban design of the local access lane can improve its function for local residents and business owners

**Basic Improvements Include:**

- Narrower entry at local access lanes
- Wider side median and narrower local access lane
- Corner curb extensions at every corner
- High visibility crosswalks with 2 curb ramps at each corner
- Special paving in furnishing zones in commercial areas
- Landscaped infiltration planters in side and center medians

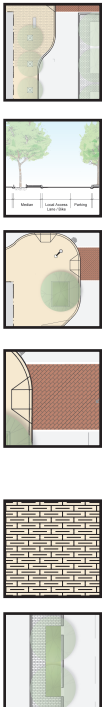

**Basic Improvements**

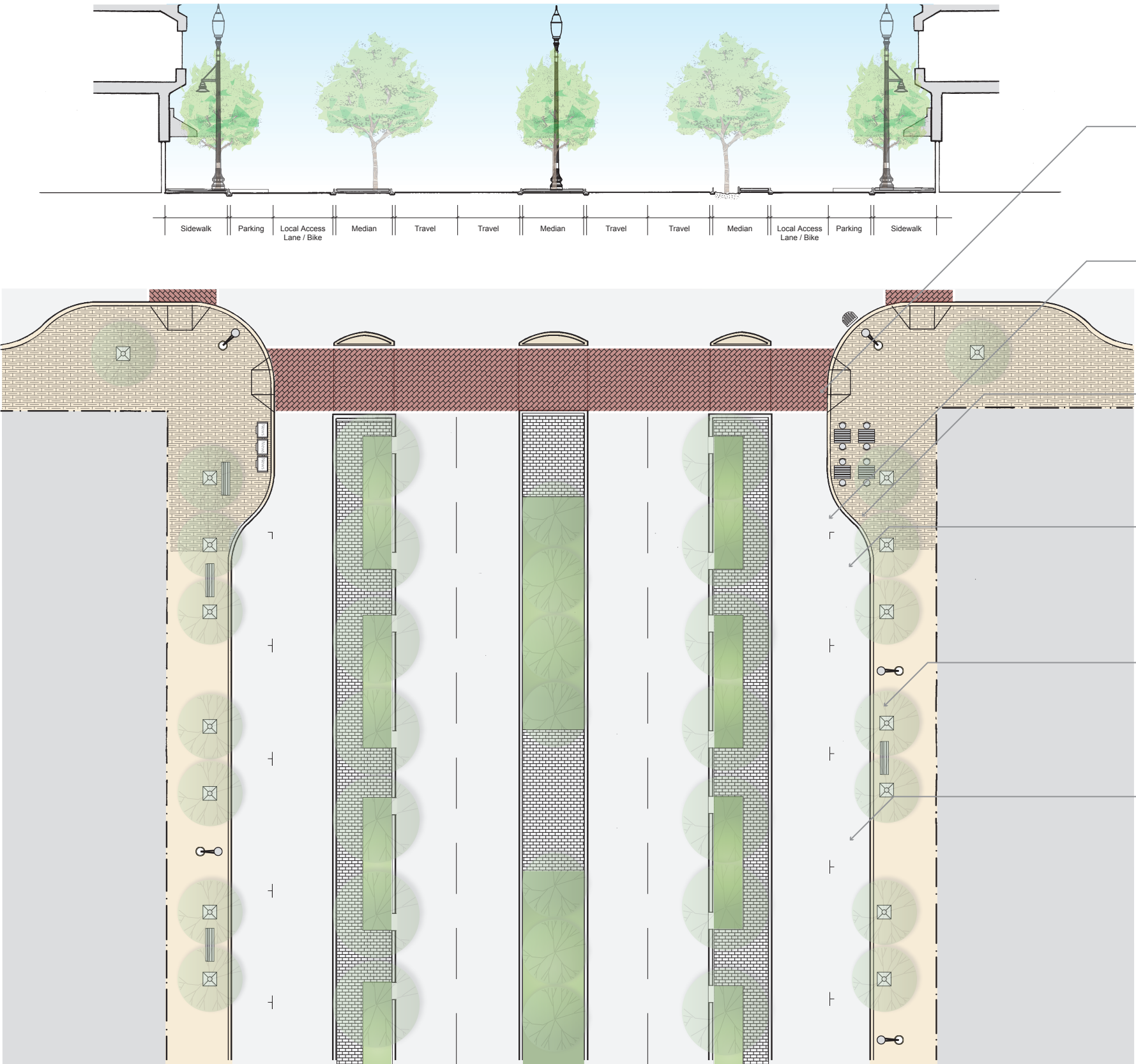

**Kit of Parts to Consider**

**Raised Crossing Across Local Access Lane:**

- Slows traffic at intersections, decreases cut-through traffic, and increases visibility of pedestrians crossings
- Installation can be costly

**Shared Street Local Access Lane (Woonerf):**

- Single surface reinforces the idea of the entire local access lane as pedestrian/neighborhood space through which vehicles may carefully pass
- Installation can be costly. ADA issues must be considered

**Trench Drain in Bulbout:**

- Adds visual interest to bulbout with attractive grate which makes access for cleaning easy and decreases the cost of bulbout because existing stormdrain does not need to be moved
- Maintenance can be costly

**Extended Bulbout/Corner Plaza:**

- Adds significant public space for seating, landscaping, and/or pedestrian amenities
- Can include trees, landscaping, and/or infiltration areas
- Installation can be costly

**Infiltration Area Boardwalks:**

- Add interesting material and texture to the sidewalk
- Create large areas for infiltration and planting
- Boardwalks are relatively easy to remove for access to utilities

**Mid-block Curb Extension Plazas:**

- Provide useable open space for landscaping, furnishings, cafe seating, and other pedestrian amenities and visually narrows the street to calm traffic
- Installation can be costly

**Multi-way Boulevard**

