



Industrial streets require many accommodations to the needs of large trucks which must navigate these streets, but must also consider the pedestrians and area workers who will use these streets.

Existing Challenges Include:

- Need to maintain proper facilities for truck turning movements, loading facilities, and safe navigation of streets
- The pedestrian realm should be safe and comfortable for pedestrians for the pedestrians who will walk or spend time on these streets

Basic Improvements Include:

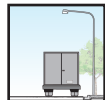
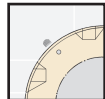
- Planting strips along building frontage where conflict with trucks is minimized 
- More consistent street trees in planting strips 
- Roadway lighting 
- 2 curb ramps at each corner 

Existing

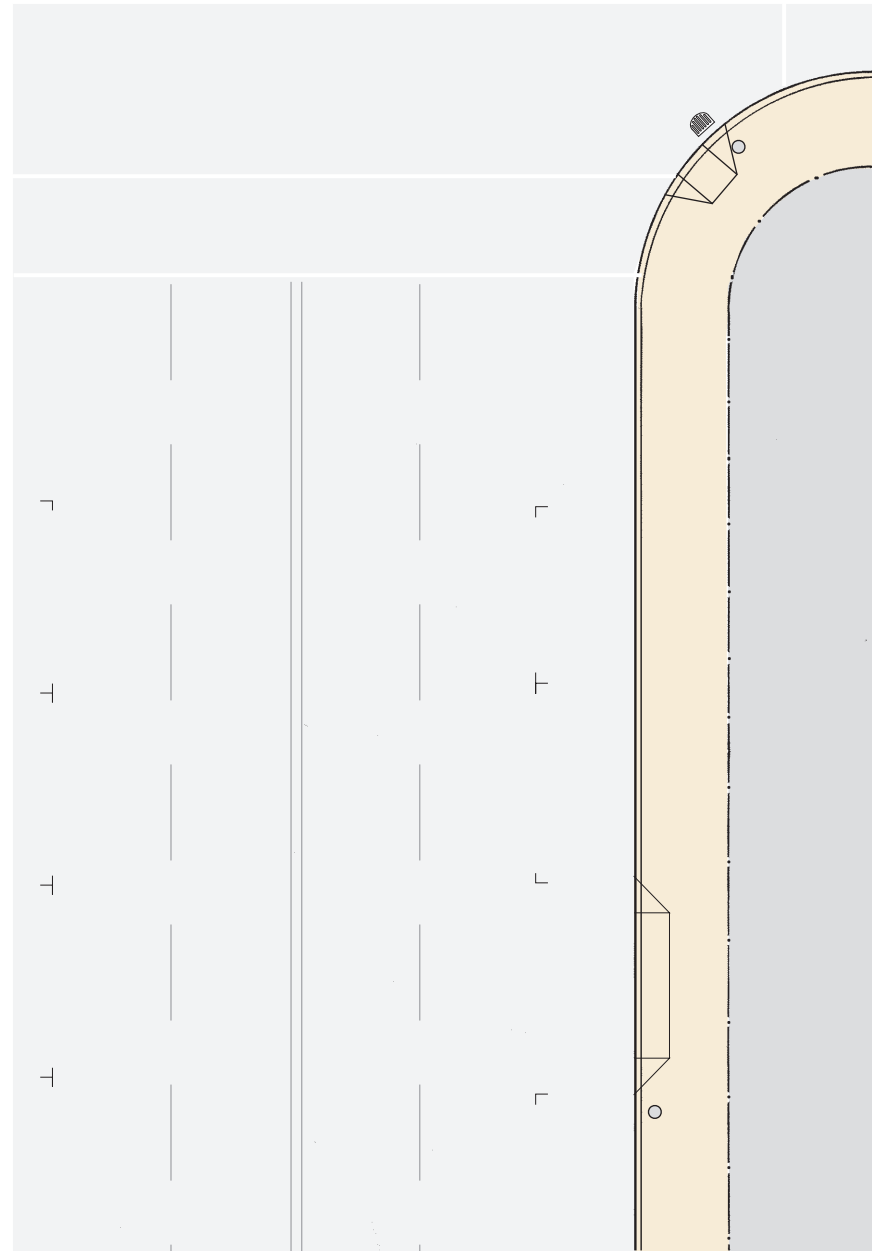
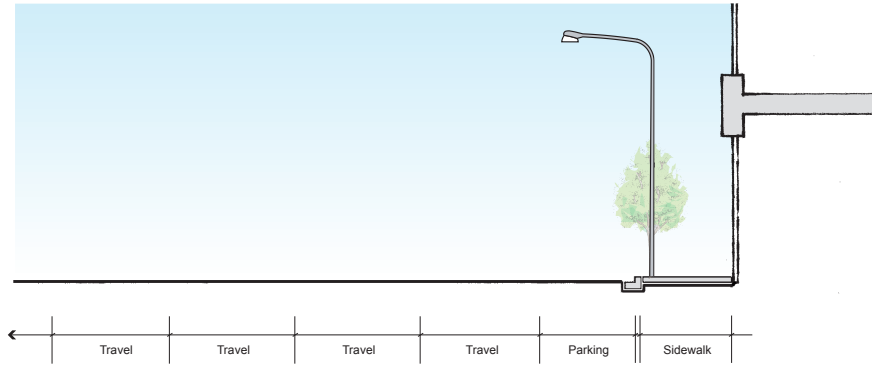

Basic Improvements

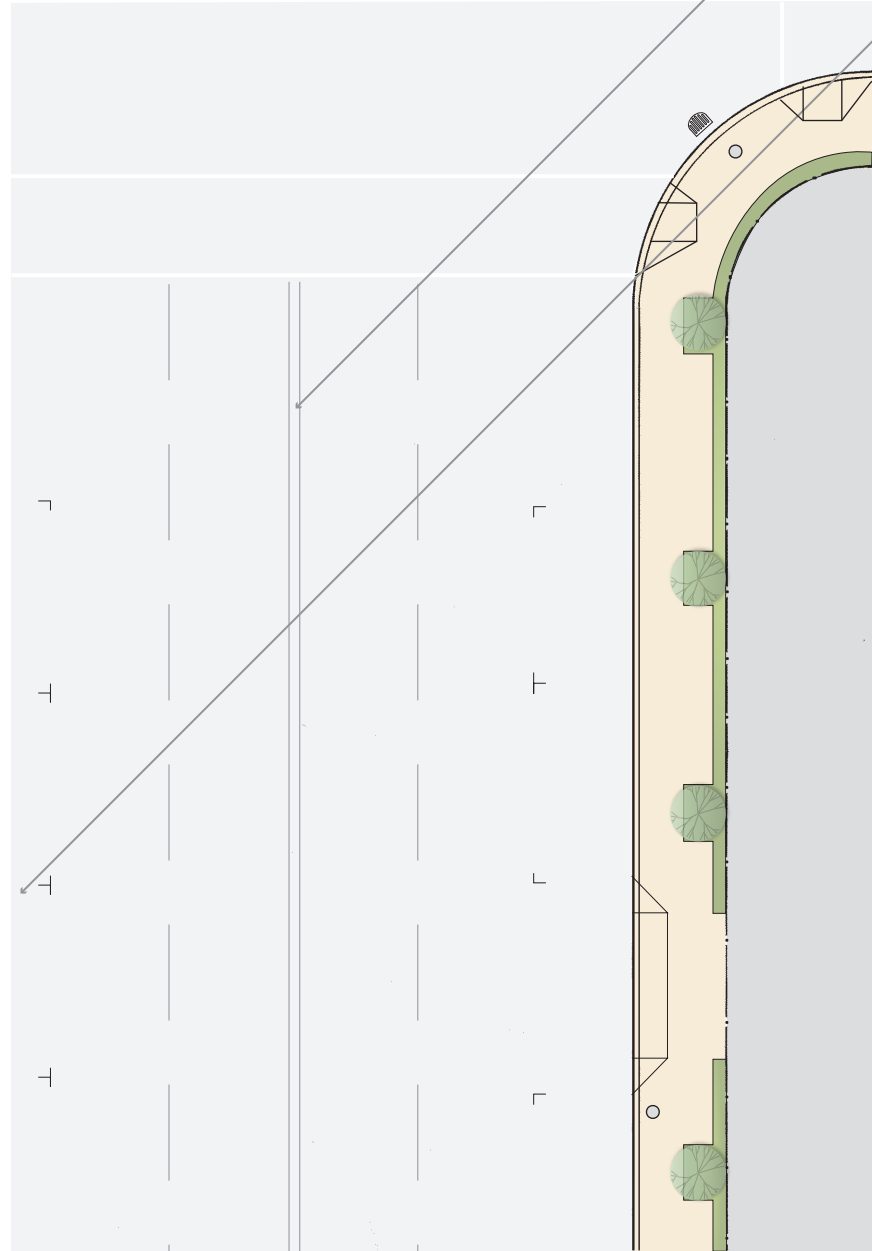
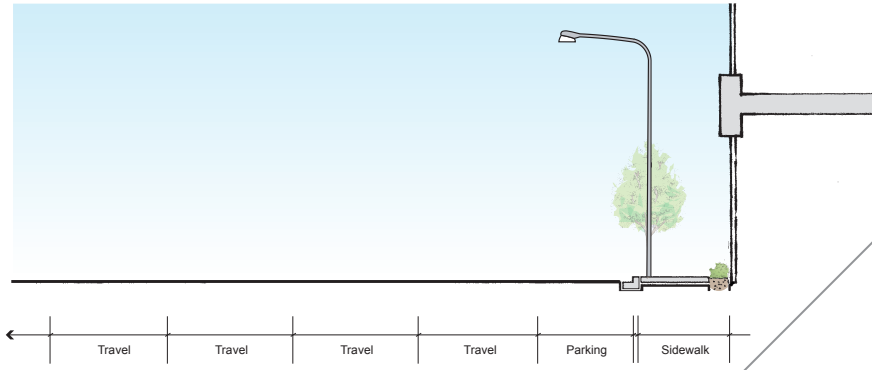

Kit of Parts to Consider

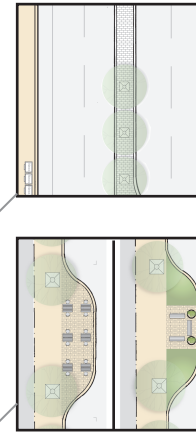

Center Median:

- Visually narrows the street to calm traffic and adds pedestrian refuge in crosswalks
- Can be landscaped with planters and/or trees
- Installation can be costly
- Need to provide breaks for turns into loading docks and driveways

Mid-block curb extension plaza:

- Provides useable open space for landscaping, furnishings, worker seating and other pedestrian amenities and visually narrows the street to calm traffic
- Installation can be costly

Industrial

