

Industrial mixed-use streets include a broad and dynamic array of uses, from light industrial uses to high-density mixed-use residential and commercial development, with demands for both high mobility of all modes of transportation, including trucks, and residential living.

Existing Challenges Include:

- Varied land uses have varied demands for street function and amenities
- These areas are rapidly changing, and require flexibility to accommodate potential future uses as well

Basic Improvements Include:

- More consistent street trees and landscaped planters
- Pedestrian-scale lighting at street corners and regular intervals
- More substantial corner curb extensions at every corner
- High visibility crosswalks with 2 curb ramps at each corner
- Combined parking meters and other measures to reduce streetscape clutter

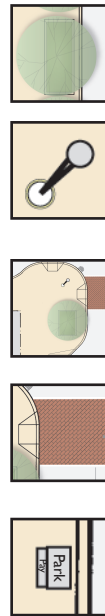

Existing

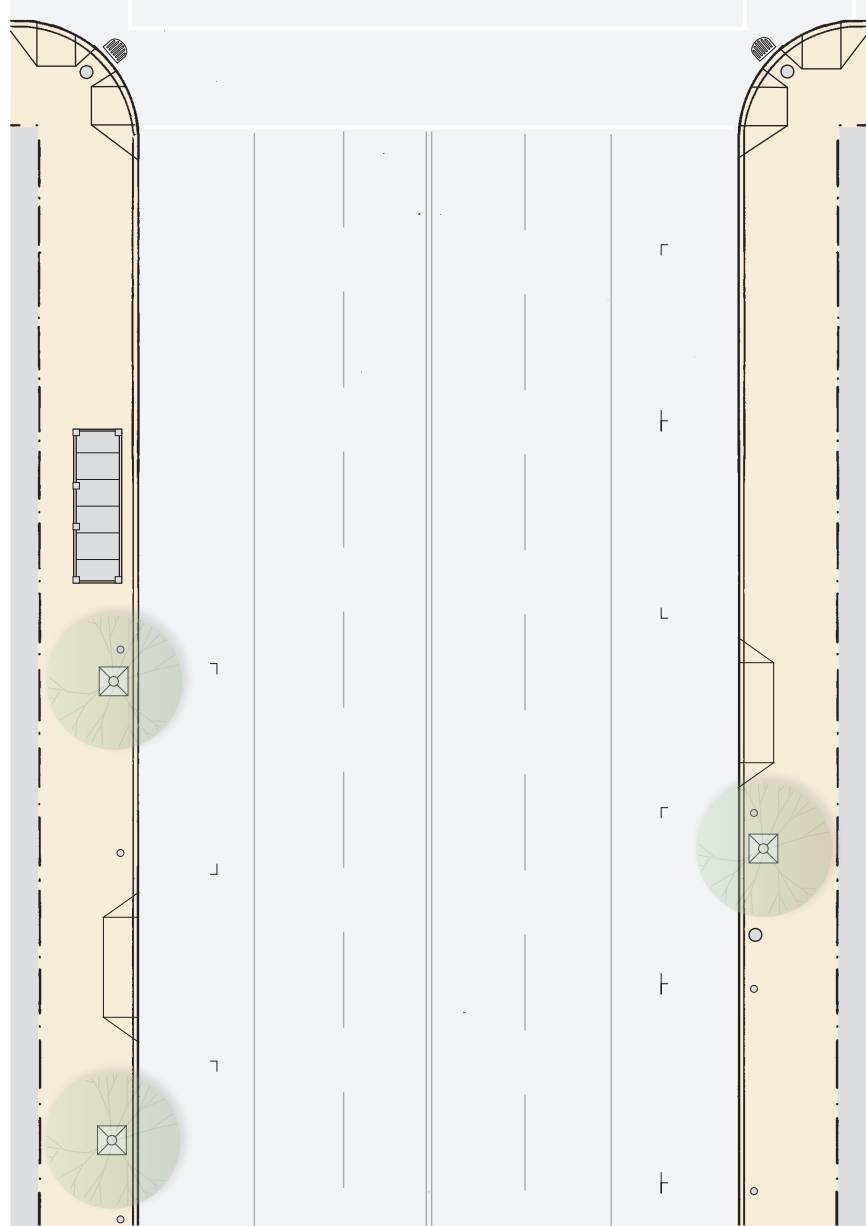
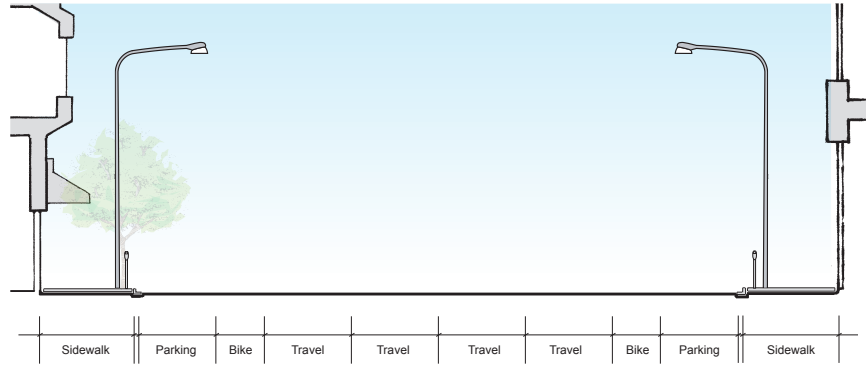

Basic Improvements

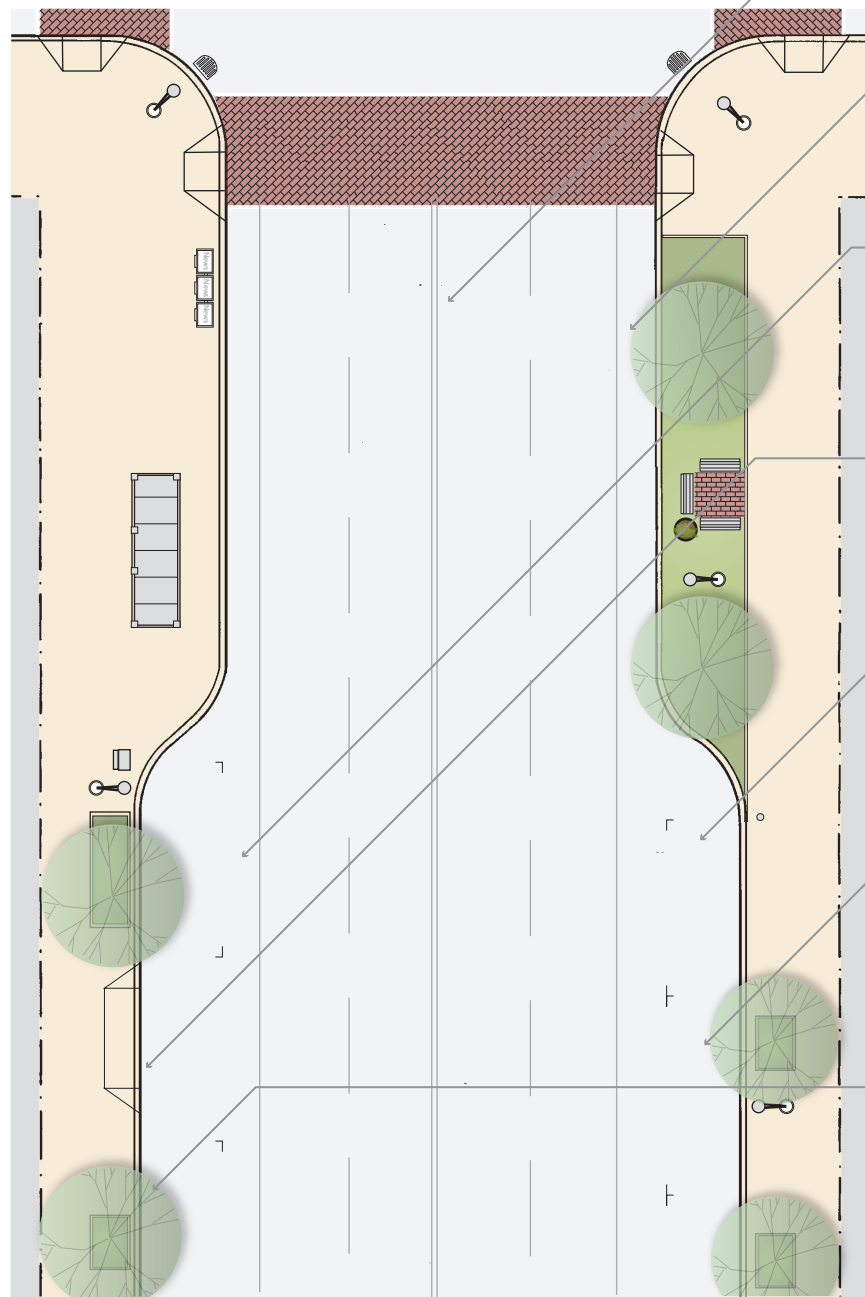

Kit of Parts to Consider

Center Median:

- Visually narrows the street to calm traffic and adds pedestrian refuge in crosswalk
- Can be landscaped with planters and/or trees
- Installation can be costly

One-side Boulevard Conversion:

- A local access lane can be added to one side to provide parking, pedestrian buffering, and more space for neighborhood use
- Requires significant street changes

Back-in Perpendicular or Angle Parking:

- Adds more parking to the street and narrows street visually to slow traffic
- Provides additional space between parking for landscaping; stalls can have permeable surface for stormwater infiltration

Curb-widening/Road Diet:

- Appropriate to locations where land use has significantly changed and pedestrian/user needs merit reconfiguration of traffic lanes
- Can be costly and requires traffic study

Parking Lane Planters:

- Add attractive trees and greenery to the streetscape and visually narrow the street to calm traffic
- Can be designed to infiltrate stormwater runoff
- Require removal of a half or whole parking space
- Can be difficult to maintain

Mid-block Crossing:

- Provides safe pedestrian crossing at mid-block locations on long blocks
- Can include trees and landscaping or seating at bulbouts
- Installation can be costly and require traffic study

Mid-block curb extension plazas:

- Provides useable open space for landscaping (pocket parks), furnishings, cafe seating and other pedestrian amenities appropriate to adjacent land use and visually narrows the street to calm traffic
- Installation can be costly and may require removal of some parking

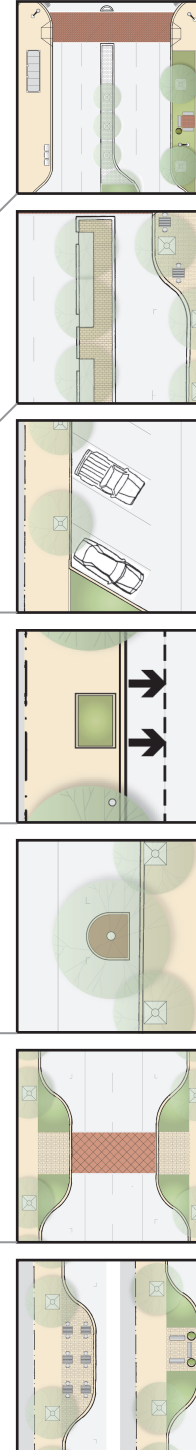

Industrial Mixed-Use

